

# Surflo<sup>®</sup> Winged Infusion Set

---

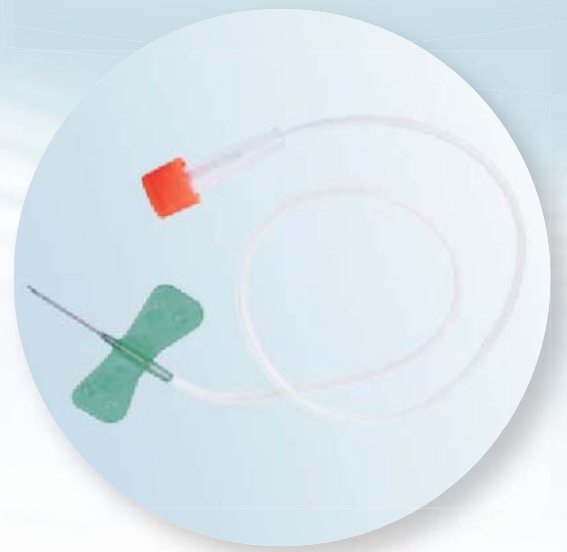
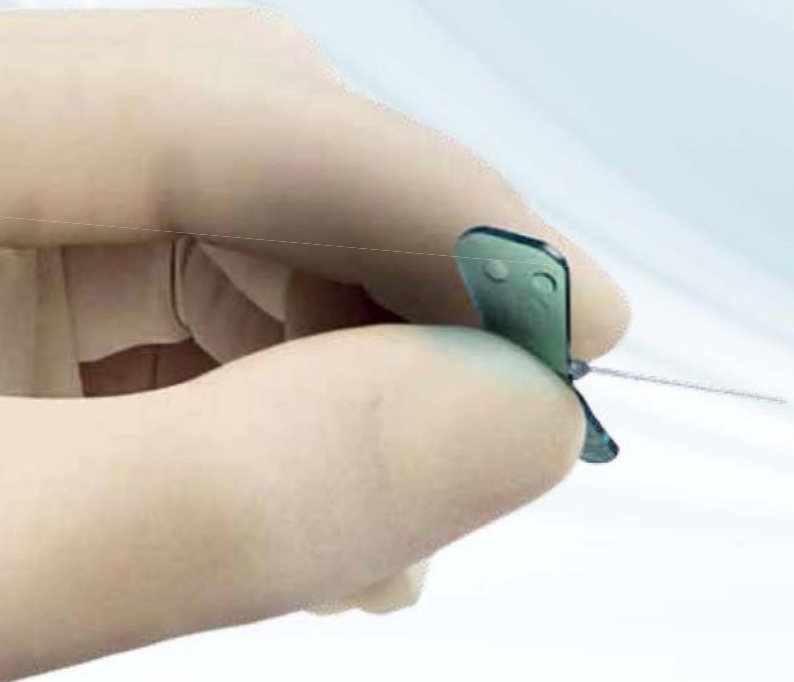

## Perform and Care

- *Smooth placement*
- *Ease of use*
- *Patient comfort*
- *User satisfaction*

# Surflo® Winged Infusion Set

## Smooth placement

Terumo® cannula technology ensures an outstanding sharpness combined with a special silicone coating allowing an easy and smooth placement.

## Ease of use

The user inspired design of the large and interlocking wings ensures a firm grip during placement. Colour coded wings and kink resistant tubings provide additional ease of use.

## Patient comfort

The excellent quality of the Terumo® cannula is at the core of minimising trauma. Patients reported having experienced an almost painless placement.

## User satisfaction

The design and performance of the Surflo® winged infusion sets are supporting a successful placement and increasing end-user satisfaction due to less discomfort caused to patients.

## Instructions for use

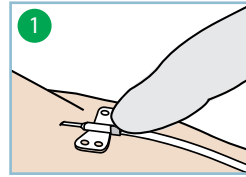

After successful infusion, hold the winged needle in place.

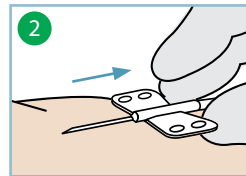

Withdraw the winged infusion set carefully from the vein.

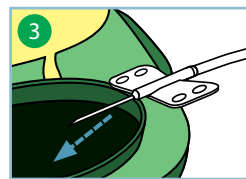

Dispose the winged infusion set after use into a disposal box.

## Products and specifications

Code	Colour	Cannula - external Ø		Cannula length	Tubing length	Dead space mL	Packaging
		G	mm				
SV*18BLK03	Pink	18	1.2	19 mm	300 mm	0.46	10 x 50
SV-19BL	Ivory	19	1.1	19 mm	300 mm	0.43	10 x 50
SV-21BL	Green	21	0.8	19 mm	300 mm	0.42	10 x 50
SV-22BL	Black	22	0.7	19 mm	300 mm	0.42	10 x 50
SV-23BL	Blue	23	0.6	19 mm	300 mm	0.41	10 x 50
SV-25BL	Orange	25	0.5	19 mm	300 mm	0.41	10 x 50
SV*27EL	Grey	27	0.4	13 mm	200 mm	0.27	10 x 100

Shelf life: 5 years; 3 years (SV\*27EL / SV\*18BLK03)



STERILE EO

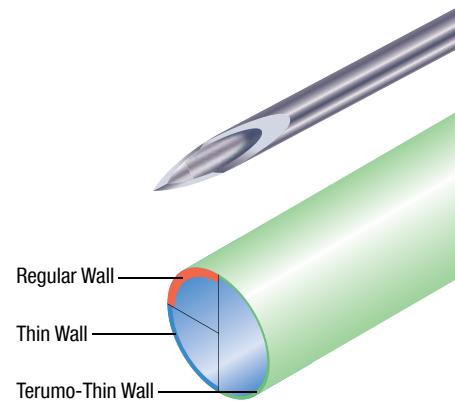

**Terumo Corporation**  
44-1, 2-chome, Hatagaya  
Shibuya-ku, Tokyo 151-0072,  
Japan  
Tel.: +81 3 3374 8111  
Fax: +81 3 3374 8196

### European Headquarters

**Terumo Europe N.V.**  
Interleuvenlaan 40  
3001 Leuven, Belgium  
Tel.: +32 16 38 12 11  
Fax: +32 16 40 02 49

### European Offices

**Terumo Europe N.V.  
Benelux Sales Division**  
Interleuvenlaan 40  
3001 Leuven, Belgium  
Tel.: +32 16 39 25 80  
Fax: +32 16 39 25 99  
The Netherlands:  
Tel.: 0800 0220396  
Fax: 0800 0220414

**Laboratoires Terumo France S.A.**  
Parc Ariane - Bât. Uranus  
1, rue Hélène Boucher  
78284 Guyancourt Cedex, France  
Tel.: +33 130 96 13 00  
Fax: +33 130 43 60 85

### Terumo Deutschland GmbH

Ludwig-Erhard-Strasse 6  
65760 Eschborn, Germany  
Tel.: +49 6196 80 230  
Fax: +49 6196 80 23 200

**Terumo Deutschland GmbH**  
Zweigniederlassung Spreitenbach  
Bodenackerstrasse 3  
8957 Spreitenbach, Switzerland  
Tel.: +41 56 419 10 10  
Fax: +41 56 419 10 11

**Terumo Europe España SL**  
Avda. Juan Carlos I, Nº 13 - 7ª Planta  
Edificio Torre La Garena  
28806 Alcalá de Henares (Madrid),  
Spain  
Tel.: +34 9021 01 298  
Fax: +34 9021 01 358

**Terumo Italia S.r.l.**  
Via Simone Martini, 143/145  
00142 Roma RM,  
Italy  
Tel.: +39 0651 96 14 20  
Fax: +39 0650 30 407

### Terumo Sweden AB

Nya Varvet, Byggnad 90  
Sven Källfelts Gata 18  
426 71 Västra Frölunda,  
Sweden  
Tel.: +46 3174 85 880  
Fax: +46 3174 85 890

**Terumo Denmark  
Filial of Terumo Sweden AB**  
Tel.: +45 7020 93 80  
Fax: +45 7020 94 80

**Terumo UK Ltd**  
Tamesis  
The Causeway  
Egham, Surrey  
TW20 9AW, United Kingdom  
Tel.: +44 1784 476 200  
Fax: +44 1784 476 201

**Terumo Europe N.V.  
Moscow Representative Office**  
BC Northern Tower  
13Fr., 10 Testovskaya Street  
Moscow 123317, Russia  
Tel.: +7 495 988 4740  
Fax: +7 495 988 4739

**Terumo Corporation Dubai Branch  
(Middle East and Africa)**  
Al Masraf Tower, 22nd Floor  
P. O. Box 20291 Dubai  
U.A.E.  
Tel.: +971 4 221 2220  
Fax: +971 4 221 3330



Addresses subject to change,  
please consult our Website.

© Registered Trademark  
Published by Terumo Europe N.V.  
HO 07GB-0406TE-V(11.12)E